

INSTALLATION PROCEDURES FOR THERMAX SHEATHING

Interior Masonry Wall Insulation

THERMAX* Sheathing is a non-structural, rigid board insulation consisting of a glass-fiber-reinforced polyisocyanurate foam core laminated between pinhole-free aluminum foil facers. A unique free-rise manufacturing process produces the uniform, closed-cell core foam, which is exceptionally resistant to heat flow. The facers of THERMAX Sheathing help provide an effective barrier to moisture.

Lightweight and easy to install, THERMAX Sheathing is ideally suited for interior masonry wall applications, above or below grade. There are three methods that can be used to successfully install THERMAX Sheathing. Each of them is outlined here, along with the benefits of each.

General Information

- THERMAX Sheathing can be left exposed without gypsum wallboard. THERMAX Sheathing can also be installed vertically or horizontally.
- THERMAX Sheathing and other combustible materials must be shielded and/or given proper clearance in a manner acceptable to building codes in areas immediately adjacent to or above combustion equipment (e.g., furnaces or chimneys) or other surfaces that could reach high temperatures.
- THERMAX Sheathing may be left exposed in storage and utility areas such as crawl

spaces, attics and basements. Install a code-approved finish where necessary to protect the insulation from damage or standing water.

- Follow local building code criteria for fire resistance in attached garages. Where insulated walls and/or ceilings separate the garage from a living space, frame walls should include a minimum of 1/2" gypsum applied to both sides; ceilings should be covered with 1/2" type X gypsum board.
- When installing THERMAX Sheathing, boards must be fitted tightly together vertically and at right angles (90 degrees). See Figure 1. End-joint gaps greater than 1/8" should be filled with spray foam such as GREAT STUFF™ Gaps & Cracks sealant or equivalent to keep a continuous air infiltration barrier and to help ensure maximum thermal efficiency across the board joints.
- To increase the moisture effectiveness of the board joints, apply aluminum foil tape or equivalent over the sprayed board joints.

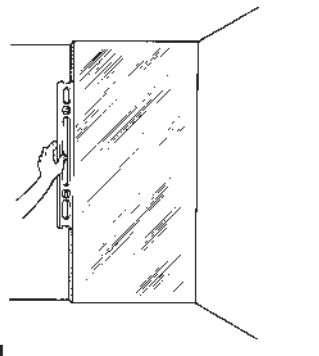

Figure 1

Materials Checklist

To install THERMAX Sheathing, you will need:

- Utility knife
- Straight edge
- Measuring tape
- Hammer
- Electric drill (for better and best practices)
- Pencil
- Aluminum foil tape
- Construction-grade adhesive
- Pressure-treated nailers

Optional Materials

(Based on preferred installation method)

- 1" x 3" or 3/4" furring strips (pressure-treated wood nailers, metal nailers, metal strips, metal hat channels or Z-furring strips) for good and better practices
- Wood or metal framing (for best practices)
- Masonry bits and screw-driver bits (for better and best practices)
- Masonry nails and screws, such as Hilti®, Stanley-Bostitch® or TapCon® (for better or best practices) (Olympic®, Trufast® and Buildex® can also provide good mechanical fasteners for concrete applications)
- Gypsum board (if desired)
- Outlet boxes (if desired)
- Electrical wire (if desired)
- Wire staples
- Caulking gun
- Polyisocyanurate-compatible polyurethane spray sealant, such as GREAT STUFF insulating foam sealant
- Safety glasses

- To increase thermal efficiency and cut down on air infiltration, fill areas behind plumbing (where THERMAX Sheathing cannot be fitted) or around window and door frames with GREAT STUFF foam sealant or equivalent.
- If fire blocking material or fire stop material is used (for example, between floors as required by local code), then sealant, caulking and/or spray foam must meet those criteria also. Check with sealant, caulking or spray foam supplier for specification for that particular area of installation only.

Sizes

Thicknesses and R-values for THERMAX Sheathing are shown in Table 1. Not all sizes are available in all parts of the country. Other product sizes are available by custom order. Consult a Dow representative for details.

TABLE 1

THERMAX SHEATHING	
Nominal Foam Thickness, in.	R-Value ^{(1), (2)}
0.5	3.3
0.75	5.0
1.0	6.5
1.25	8.0
1.55	10.0
1.75	11.4
2.0	13.0
2.5	15.8
3.0	19.0
3.5	22.1
4.0	25.3

(1) R means resistance to heat flow. The higher the R-value, the greater the insulating power.
 (2) R-value determined by ASTM C518.

Cutting

There are two ways to cut THERMAX Sheathing. One way is to use a straight edge and a utility knife, making sure to cut all the way through the facing. Make sure the surface backing is safe to cut on. Or, THERMAX Sheathing may be cut with a small handsaw. See Figures 2a and 2b. Safety precautions should be taken with either method.

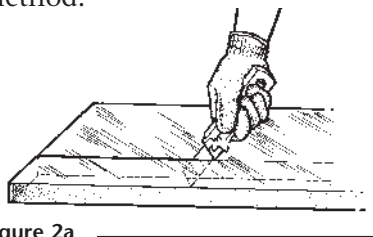

Figure 2a

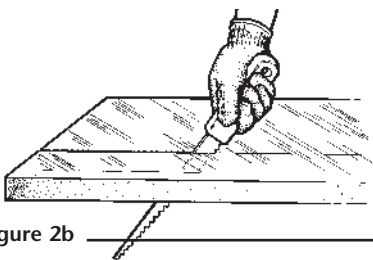

Figure 2b

Installation

Good Method

Figure 3 shows a good method to install THERMAX Sheathing.

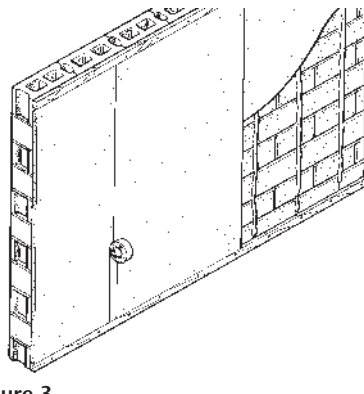

Figure 3

1. Install furring strips (nailers), the same thickness as the THERMAX Sheathing being installed, to the top and bottom of the wall.

2. Apply a compatible construction-grade adhesive to the wall, following manufacturer instructions. THERMAX Sheathing is then installed between the furring strips.
3. Cover seams between boards of THERMAX Sheathing with aluminum foil tape or equivalent.
4. If a finished wall is desired, gypsum wallboard or paneling can be installed by attaching to the furring strips (nailers) at the top and bottom. Baseboard and top molding can also be installed using mechanical fasteners.

Note: Always follow adhesive manufacturer instructions when applying adhesive for pressure needed to form bond (if required), proper cure times and recommended application temperatures.

Better Method

Figure 4 shows a better method to install THERMAX Sheathing.

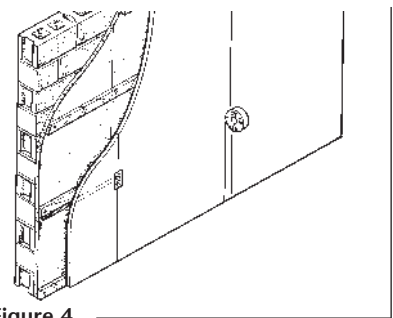

Figure 4

1. Apply a compatible construction-grade adhesive to the wall, following manufacturer instructions. Adhere THERMAX Sheathing directly to the wall to temporarily secure it until furring is attached.
2. Cover seams between boards of THERMAX Sheathing with aluminum foil tape or equivalent.

3. Install 3/4" furring strips either 16" or 24" on center, vertically or horizontally, using mechanical fasteners. With electric drill and masonry bit, drill holes through the furring strips 1-1/2" into the block wall. See Figure 5. Concrete fasteners should be longer than the insulation board thickness. (To secure strips to wall, use three or four screws per 8' length.)

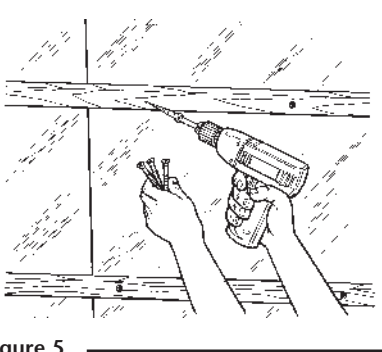

Figure 5

4. Install any electrical boxes to the furring strips.
5. Gypsum wallboard or paneling may be nailed to the furring strips with fasteners short enough not to penetrate through to the insulating sheathing. The space between the insulation and gypsum wallboard can create a reflective dead air space, adding an R-value of 2.8 at no additional cost, or the space can be used as a raceway for wiring.

Best Method

Figure 6 shows the best method to install THERMAX Sheathing. It shares all the benefits of the better method, but eliminates the penetration of thermal-transmitting metal fasteners through the insulating sheathing.

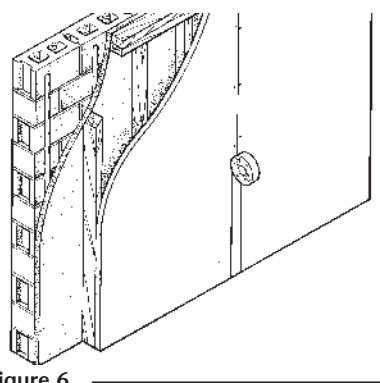

Figure 6

1. Apply a compatible construction-grade adhesive to the wall, following manufacturer instructions. Adhere THERMAX Sheathing directly to the wall to temporarily secure the boards until the furring framework is installed.
2. Cover seams between boards of THERMAX Sheathing with aluminum foil tape or equivalent.
3. Construct a wood or metal framework with either 16" or 24" on center studs. Fasten the framework directly to the ceiling joints or flooring with mechanical fasteners.
4. Install any electrical boxes directly to the studs.
5. Gypsum wallboard or paneling may be nailed to the studs with fasteners short enough not to penetrate through to the insulating sheathing. The space between the insulation and gypsum wallboard can create a reflective dead air space, adding an R-value of 2.8 at no additional cost, or the space can be used as a raceway for wiring.

For commercial applications, a THERMAX Sheathing product is available, with a white embossed aluminum facer for exposed use. Please consult your Dow representative for additional information.

Measuring For Exact Fit

THERMAX Sheathing can be installed in tight spaces, even if the wall is uneven.

1. Position insulation board squarely against corner, overlapping the inside edge of the last board installed (Figure 7).

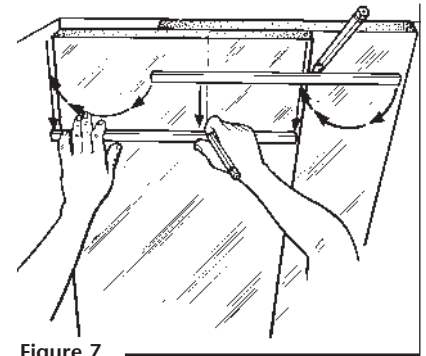

Figure 7

2. Using a 2'-long stick, measure from the outside edge of the last board installed to the outside edge of the new board (distance 'A'). Mark 'A' on stick.
3. Place stick against wall. With a pencil at 'A,' move it down the board to be cut.
4. Cut board at marked line.
5. Install overlap piece.

IN THE U.S.:

- For Technical Information: **1-866-583-BLUE (2583)**
- For Sales Information: **1-800-232-2436**

THE DOW CHEMICAL COMPANY

- Building Materials • 200 Larkin • Midland, MI 48674

www.dowstyrofoam.com/architect (Commercial) • **www.insulateyourhome.com** (Residential)

NOTICE: No freedom from any patent owned by Dow or others is to be inferred. Because use conditions and applicable laws may differ from one location to another and may change with time, Customer is responsible for determining whether products and the information in this document are appropriate for Customer's use and for ensuring that Customer's workplace and disposal practices are in compliance with applicable laws and other government enactments. Dow assumes no obligation or liability for the information in this document. NO WARRANTIES ARE GIVEN; ALL IMPLIED WARRANTIES OF MERCHANTABILITY OR FITNESS FOR A PARTICULAR PURPOSE ARE EXPRESSLY EXCLUDED.

COMBUSTIBLE: THERMAX products should be used only in strict accordance with product application instructions. THERMAX products, when used in a building containing combustible materials, may contribute to the spread of fire. For more information, consult MSDS and/or call Dow at 1-866-583-BLUE (2583). In an emergency, call 1-989-636-4400.

WARNING: THERMAX insulation does not constitute a working walkable surface or qualify as a fall protection product.

Building and/or construction practices unrelated to insulation could greatly affect moisture and the potential for mold formation. No material supplier including Dow can give assurance that mold will not develop in any specific system.



Living.
Improved daily.